

HIGH VOLTAGE TEST SYSTEM GHV3000-50

HIGH VOLTAGE TEST SYSTEM WITH ELECTRONIC POWER SOURCE

This powerful test system provides a voltage up to 100kV for testing medium voltage components such as power transformers, switchgear, motors and cables.

The separate control unit allows the operation of the high voltage tests at a safe distance.

By the innovative and efficient frequency converter technique, a sinusoidal output voltage with low harmonic is generated.

The voltage is precisely measured and regulated.

The complete remote control via PC allows safe testing from the control room and increases safety and productivity.

APPLICATION

- Applied AC High Voltage Tests
- Power Transformers
- Switchgear
- Motors
- Cables

KEY FEATURES

- Applied AC High Voltage Test
- Voltage up to 100kV
- Current up to 4000mA
- Power 50kVA
- Frequency 50-60Hz
- Safety according to EN50191
- Touch display
- Ethernet interface

KEY BENEFITS

- Precise Voltage Regulation
- Fast Voltage Adjustment
- Voltage Ramps functions
- Available for PD tests
- Full Remote Control from PC

GHV3000-50 TECHNICAL SPECIFICATIONS

50kVA HIGH VOLTAGE TEST SYSTEM 12kV...100kV

Model	GHV3000-50-12	GHV3000-50-25	GHV3000-50-50	GHV3000-50-100
Output power (60s ON, 180s OFF)	50kVA			
Output power continuous	25kVA			
Output range ¹⁾²⁾	12kV 4000mA	25kV 2000mA	50kV 1000mA	100kV 500mA
Output frequency	50-60Hz ²⁾			
High voltage transformer	Single pole, oil-insulated, maintenance-free, cylinder type			
Input voltage	3AC 400V±5% 50-60Hz ²⁾			
Input current	80A max.			
Measurements	Output voltage, Output current, Transformer input current Current accuracy 1.0% of range Voltage accuracy 2.0% of range			
Protections	Adjustable overcurrent limit, overvoltage, overtemperature			
Safety features	Internal emergency stop, connection for external emergency stop, connection for one safety interlock, warning lights, key switch, start and stop buttons			
Control unit dimensions (WxHxD)	1200mmx2100mmx800mm			
Control unit	470kg			
Dimensions HV unit (WxHxD) [mm]	On request	On request	On request	On request
Weight HV Unit	On request	On request	On request	On request

¹⁾ for 60s ON, 180s OFF output current 50% for continuous operation ²⁾ other values available on request

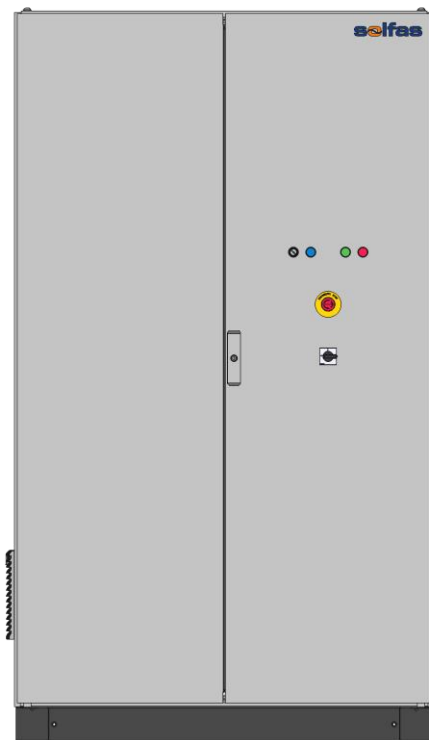
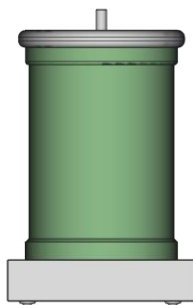

SOLFAS TECHNOLOGIE GMBH

We specialize in the development and distribution of test systems, power supplies and measuring instruments. Experts in electrical testing and automation, our company offers a broad range of high-performance full-service testing solutions and measuring instruments. We provide clients in the automotive, aerospace, energy and traditional industry sectors with the equipment they need to test high power components, such as chokes, transformers and electric motors.